

# Simple, Compact Dryer Box

## Dryer Outlet Box

The Dryer Outlet Box is designed to fit standard 16" center stud construction which uses 2x4's or 2x6's. The standard 4" diameter knockouts provide full airflow and the six most common positions are pre-scored to make punch-out quicker. The pre-scored plastic can be cut with a sturdy pocket-knife. Additional knockouts may require a utility knife.



### FEATURES & BENEFITS

- One self-trimming unit: 18" w x 24" h.
- Fits all 16" centers 2x4's and 2x6's.
- Six pre-scored, true 4" diameter knockouts in most common positions.
- Four starburst knockouts for gas connections and venting.
- Plastic meets UL standard 94HB tests for flammability.

### TECHNICAL DRAWINGS

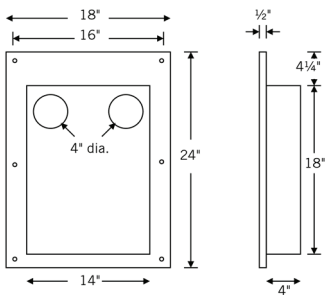

### COLOURS

- White

### PART NUMBER/SIZING

Part #	Description	Qty
DB18x24B	Dryer Outlet Box - Bulk	10

### APPLICATIONS

